

Nylon Insert Hexagon Nut DIN 985

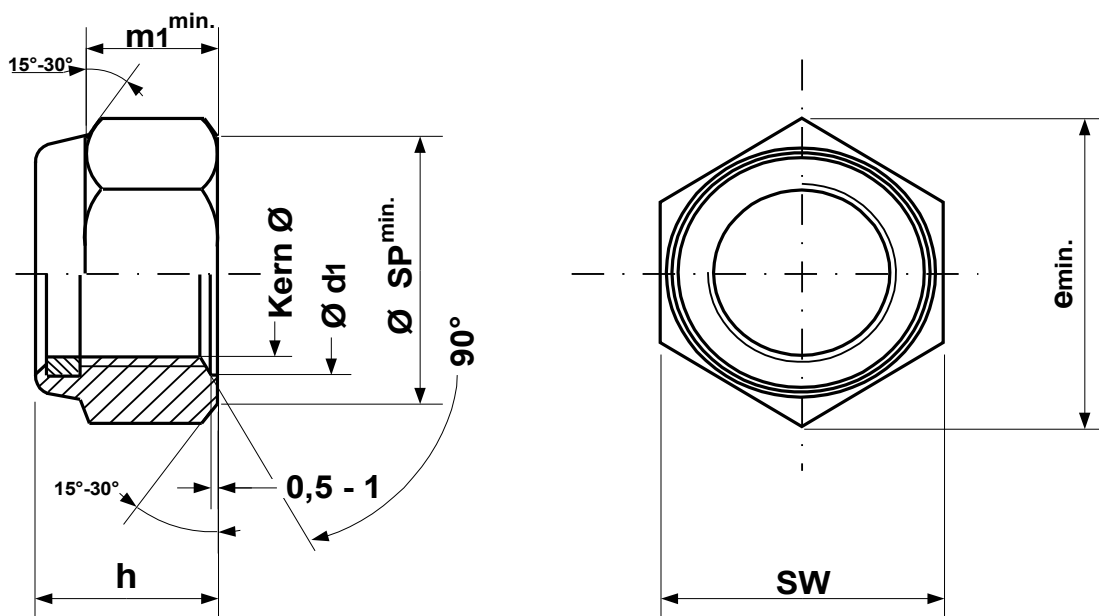

Sorte		Einsatzg.	SW	h	KernØ	min. m1	min. ØSP		Ød1
		Fertigg.							
M 16	DIN 985	42,0 g	24,00	16,00	14,210	10,5	22,5		17,3
		29,2 g	23,67	15,30	13,835				16,0
M 18	DIN 985	65,1 g	27,00	18,50	15,744	13,0	24,9		19,5
		44,4 g	26,16	17,66	15,294				18,0
M 20	DIN 985	87,9 g	30,00	20,00	17,744	14,0	27,7		21,6
		59,9 g	29,16	18,70	17,294				20,0
M 22	DIN 985	104,8 g	32,00	22,00	19,744	15,0	29,5		23,7
		69,8 g	31,00	20,70	19,294				22,0
M 24	DIN 985	135,5 g	36,00	24,00	21,252	15,0	33,2		25,9
		100,0 g	35,00	22,70	20,752				24,0
M 27	DIN 985	212,7 g	41,00	27,00	24,252	17,0	38,0		29,1
		144,7 g	40,00	25,70	23,752				27,0
M 30	DIN 985	308,0 g	46,00	30,00	26,771	19,0	42,7		32,4
		212,0 g	45,00	28,70	26,221				30,0
M 33	DIN 985	398,0 g	50,00	33,00	29,771	22,0	46,6		35,6
		272,0 g	49,00	31,40	29,211				33,0
M 36	DIN 985	536,4 g	55,00	36,00	32,270	25,0	51,1		38,9
		378,7 g	53,80	34,40	31,670				36,0
M 39	DIN 985	649,2 g	60,00	39,00	35,270	27,0	55,9		42,1
		464,2 g	58,80	37,40	34,670				39,0
M 42	DIN 985	787,0 g	65,00	42,00	37,799	29,0	60,6		45,4
		602,0 g	63,80	40,40	37,129				42,0
M 45	DIN 985	1145,0 g	70,00	45,00	40,799	32,0	64,7		48,6
		875,0 g	68,10	43,40	40,129				45,0
M 48	DIN 985	1227,0 g	75,00	48,00	43,297	36,0	69,4		51,8
		928,0 g	73,10	46,40	42,587				48,0
M 52	-	1327,0 g	80,00	52,00	47,297	41,0	74,2		56,8
		1132,0 g	78,10	51,40	46,587				52,0
M 56	-	1690,0 g	85,00	56,00	50,796	47,0	78,7		60,5
		1570,0 g	83,10	55,40	50,046				56,0