

# **Sechskantmutter mit Klemmteil** **nicht metallischer Einsatz (Nylon)** **ISO 7040**

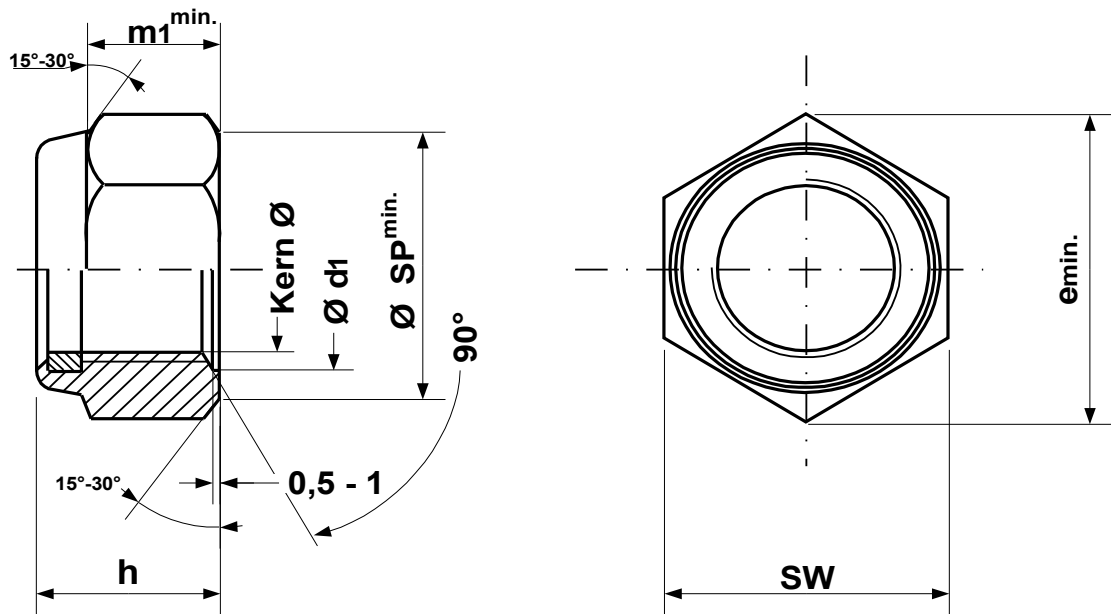

| Sorte | Einsatzg. | SW    | h     | KernØ  | min. | min. |  | Ød1  |
|-------|-----------|-------|-------|--------|------|------|--|------|
|       | Fertigg.  |       |       |        | m1   | ØSP  |  |      |
| M 16  | 42,0 g    | 24,00 | 19,10 | 14,210 | 14,1 | 22,5 |  | 17,3 |
|       | 29,2 g    | 23,67 | 17,80 | 13,835 |      |      |  | 16,0 |
| M 20  | 87,9 g    | 30,00 | 22,80 | 17,744 | 16,9 | 27,7 |  | 21,6 |
|       | 59,9 g    | 29,16 | 20,70 | 17,294 |      |      |  | 20,0 |
| M 24  | 135,5 g   | 36,00 | 27,10 | 21,252 | 20,2 | 33,2 |  | 25,9 |
|       | 100,0 g   | 35,00 | 25,00 | 20,752 |      |      |  | 24,0 |
| M 30  | 308,0 g   | 46,00 | 32,60 | 26,771 | 24,3 | 42,7 |  | 32,4 |
|       | 212,0 g   | 45,00 | 30,10 | 26,221 |      |      |  | 30,0 |
| M 36  | 536,4 g   | 55,00 | 38,90 | 32,270 | 29,4 | 51,1 |  | 38,9 |
|       | 378,7 g   | 53,80 | 46,40 | 31,670 |      |      |  | 36,0 |